



| P500 PRESSURE SENSOR

The P500 incorporates Kavlico's 4th generation ceramic capacitive sense element with the latest state of the art proprietary ASIC. Available in brass or stainless steel housings, this multi-purpose sensor is rugged by design. Highly reliable, the P500 is ideal for measuring a broad range of process media including hydrocarbon based fluids, air, and gases. The P500 package has a built-in Metri-Pack 150 series sealed electrical connector and is available with popular pressure connection thread options. The sensor is offered with seal materials suitable for diverse applications. Standard pressure ranges are available in PSI or Bar.



Features

- Small Size (3/4" Hex)
- External Hex for Easy Installation
- Linear Amplified Output
- Temperature Compensated
- Superior Long-Term Stability
- Low Power Consumption
- Minimum Life Expectancy: Ten Million Cycles

Applications

- Compressors
- Process Controls
- Instruments & Test Equipment
- Sterilizers
- Air Pressure
- Oil & Fuel Pressure
- Coolant Pressure
- Agricultural Equipment
- CNG & Natural Gas Engines

● SPECIFICATIONS

Pressure Ranges	0 - 1 up to 0 - 70 Bar, 0 - 15 up to 0 - 1000 PSI
Electrical Connection	Packard Electric Metri-Pack 150 Series
Pressure Connection	1/4-18 NPT (external), 1/8-27 NPT (external) - for more options see how to order
Housing Material	Brass (up to 300 psi) and stainless steel (above 300 psi)
Output Voltage	0.5 to 4.5 Vdc

● TECHNICAL SPECIFICATIONS

Pressure Ranges

Bar A, S or G	0 - 6	0 - 10	0 - 40	0 - 70
PSI A, S or G	0 - 75	0 - 100	0 - 300	0 - 750

For custom pressure ranges consult Kavlico Pressure Sensors.

Physical

Durability/Service Life	10 million full pressure cycles (minimum)
Proof Pressure	3X FS Pressure (upto 14 Bar / 200 PSI) 2X FS Pressure (above 14 Bar / 200 PSI)
Burst Pressure	1500 PSI (upto 24 Bar / 350 PSI) 2500 PSI (above 24 Bar / 350 PSI)
Humidity	93 +/- 3% RH
Vibration	10 g's peak to peak sine (10 - 2000 Hz)
Shock	75 g's, 1/2 Sine Wave
Drop Test	1 meter drop on concrete as per SAE J1455
Weight	< 50 gm
Ingress Protection	IP67

Performance

Linearity Error	$\leq \pm 0.5\%$ of span
Total Error Band	$\pm 1.5\%$ of span ($0 \leq T \leq 85\text{ C}^\circ$) $\pm 2.0\%$ of span ($T < 0\text{ C}^\circ, T < 85\text{ C}^\circ$)
Stability Coefficient	$\pm 0.3\%$ of Full span over 1 year
Operating Temperature	-40 C° to 125 C° (Seal material dependent. See Ordering Options)
Storage Temperature	-40 C° to 125 C° (Seal material dependent. See Ordering Options)

Electrical

Supply Voltage	5.0 Vdc ± 0.5
Output Voltage	0.5 to 4.5 Vdc
Supply Current	$\leq 5\text{ mA}$
Output Impedance	$\leq 100\ \Omega$
Output load	$\geq 10\text{ K}\Omega$
Output response time	$\leq 2\text{ ms}$ to 63 % of final output voltage with step change in input pressure
Overvoltage protection	36 Vdc
Reverse Voltage	-36 Vdc
Short Circuit protected	Output to supply, Output to Ground: Indefinite
Isolation Voltage	$R \geq 100\text{ M}\Omega$, 500 Vdc / 1 min
Warmup time	3 mSec Max.
EMC	Meets ISO 7637-3, ISO 11452-4, ISO 11452-2, CISPR 25, MIL-STD 461 E
ESD	IEC 1000-4.2 (8kV contact, 15kV air), ISO 10605 (8kV contact, 25kV air)

DIMENSIONS

Dimensions in mm [Inch]

Pressure Sensor with Electrical Connection

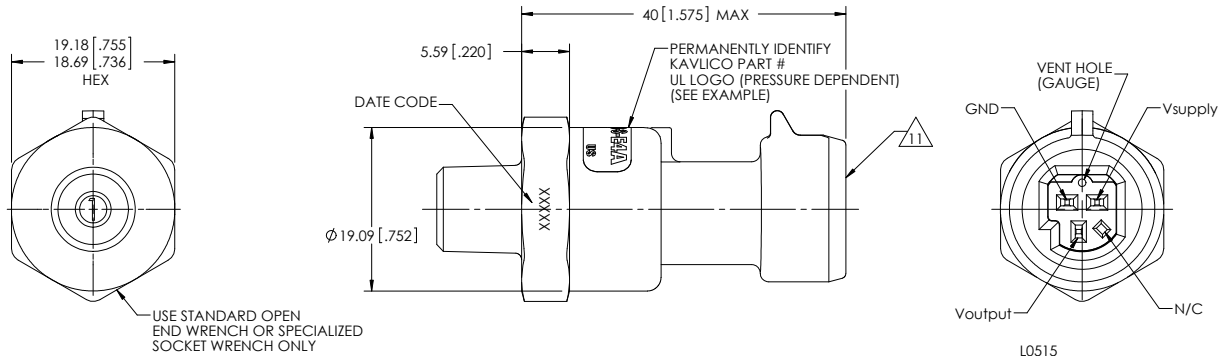

Pressure Connections and Recommended Installation Torque

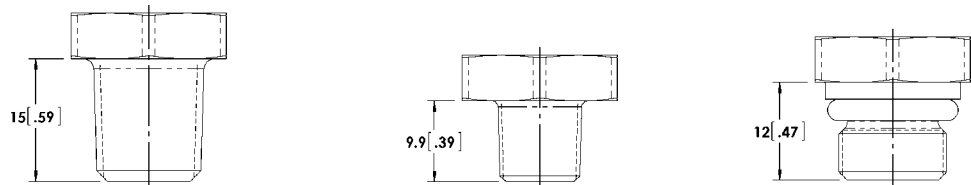

Name	1/4 - 18 NPT	1/8 - 27 NPT	Stud End DIN 3852-B-G1/4
Thread	External	External	External
Torque	25 Nm	20 Nm	20 Nm

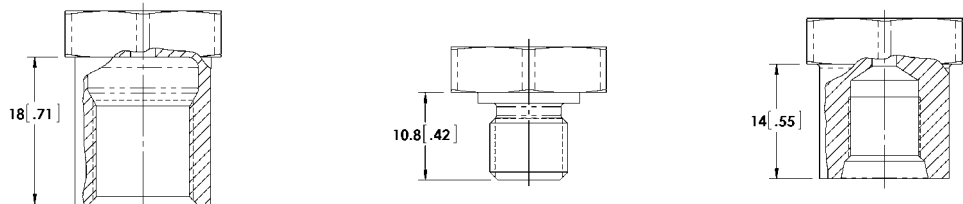

Name	Tapped Hole DIN 3852-Y-G1/4	3/8-24 UNF-2A PER SAE J 1926/2	3/8-24 UNF-2B PER SAE J 1926/1
Thread	Internal	External	Internal
Torque	15 Nm	22 Nm	22 Nm

ORDERING OPTIONS

Example: P500-1B-A-E-1-A

P500 Sensor, 0 - 16 Bar Absolute, Fluorosilicone Seal Material, 1/4 - 18 NPT Pressure Connection, with Mating Connector

Family	P500	1B	A	E	1	A
P500						
Pressure Ranges						
6B: 0 – 6 Bar	75: 0 – 75 PSI					
10B: 0 – 10 Bar	100: 0 – 100 PSI					
40B: 0 – 40 Bar	300: 0 – 300 PSI					
70B: 0 – 70 Bar	750: 0 – 750 PSI					
Reference						
A: Absolute						
G: Gage						
S: Sealed Gage (Referenced to 14.7 PSIA)						
Seal Material						
D: Fluorocarbon / Viton (-25° to +125°C)						
E: Fluorosilicone (-40° to 125°C)						
F: Ethylene Propylene (-30° to 120°C)						
Pressure Connection (Port)						
1: 1/4 - 18 NPT (External Threads)						
4: 1/8 - 27 NPT (External Threads)						
5: Stud End DIN 3852-B-G 1/4 (External Threads)						
6: Tapped Hole DIN 3852-Y-G 1/4 (Internal Threads)						
9: 3/8 - 24 UNF-2A Per SAE J1926/2 (External Threads)						
10: 3/8 - 24 UNF-2B Per SAE J1926/1 (Internal Threads)						
Built-in Electrical Connection						
A: With Mating Connector, w/12", 18 AWG Leads						
C: Without Mating Connector						

AGENCY APPROVALS & CERTIFICATIONS

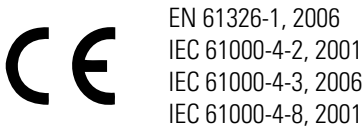

2002/95/EC RoHS Directive



File # SA10552

Datasheets provided by Sensata Technologies, Inc., its subsidiaries and/or affiliates ("Sensata") are solely intended to assist third parties ("Buyers") who are developing systems that incorporate Sensata products (also referred to herein as "components"). Buyer understands and agrees that Buyer remains responsible for using its independent analysis, valuation, and judgment in designing Buyer's systems and products. Sensata datasheets have been created using standard laboratory conditions and engineering practices. Sensata has not conducted any testing other than that specifically described in the published documentation for a particular datasheet. Sensata may make corrections, enhancements, improvements, and other changes to its datasheets or components without notice.

Buyers are authorized to use Sensata datasheets with the Sensata component(s) identified in each particular datasheet. HOWEVER, NO OTHER LICENSE, EXPRESS OR IMPLIED, BY ESTOPPEL OR OTHERWISE TO ANY OTHER SENSATA INTELLECTUAL PROPERTY RIGHT, AND NO LICENSE TO ANY THIRD PARTY TECHNOLOGY OR INTELLECTUAL PROPERTY RIGHT, IS GRANTED HEREIN. SENSATA DATASHEETS ARE PROVIDED "AS IS". SENSATA MAKES NO WARRANTIES OR REPRESENTATIONS WITH REGARD TO THE DATASHEETS OR USE OF THE DATASHEETS, EXPRESS, IMPLIED, OR STATUTORY, INCLUDING ACCURACY OR COMPLETENESS. SENSATA DISCLAIMS ANY WARRANTY OF TITLE AND ANY IMPLIED WARRANTIES OF MERCHANTABILITY, FITNESS FOR A PARTICULAR PURPOSE, QUIET ENJOYMENT, QUIET POSSESSION, AND NON-INFRINGEMENT OF ANY THIRD PARTY INTELLECTUAL PROPERTY RIGHTS WITH REGARD TO SENSATA DATASHEETS OR USE THEREOF.

All products are sold subject to Sensata's terms and conditions of sale supplied at www.sensata.com. SENSATA ASSUMES NO LIABILITY FOR APPLICATIONS ASSISTANCE OR THE DESIGN OF BUYERS' PRODUCTS. BUYER ACKNOWLEDGES AND AGREES THAT IT IS SOLELY RESPONSIBLE FOR COMPLIANCE WITH ALL LEGAL, REGULATORY, AND SAFETY-RELATED REQUIREMENTS CONCERNING ITS PRODUCTS, AND ANY USE OF SENSATA COMPONENTS IN ITS APPLICATIONS, NOTWITHSTANDING ANY APPLICATIONS-RELATED INFORMATION OR SUPPORT THAT MAY BE PROVIDED BY SENSATA.

Mailing Address: Sensata Technologies, Inc., 529 Pleasant Street, Attleboro, MA 02703, USA

CONTACT US

Americas

+1 (800) 350 2727
sensors@sensata.com
switches@sensata.com

Europe, Middle East & Africa

+359 (2) 809 1826
pressure-info.eu@sensata.com

Asia Pacific

sales.isasia@list.sensata.com
 China +86 (21) 2306 1500
 Japan +81 (45) 277 7117
 Korea +82 (31) 601 2004
 India +91 (80) 67920890
 Rest of Asia +886 (2) 27602006
 ext 2808